



## Commercial Sectional Steel Doors

### H-340S

25 Gauge / 1½" Sections

#### Strength and Energy-Efficiency

Hörmann commercial steel doors are available in a wide range of styles, sizes and design options. Sophisticated engineering and state-of-the-art manufacturing provide the basis for durable, reliable and long-lasting quality products.

**1½" thick 25 gauge** H-340S series offer an R-value of 7.4 and a 3-layer bonded construction with a hot-dipped galvanized finished steel front and back enclosing a HCFC-free polystyrene core. No matter which door suits your needs best, all H-340S doors are manufactured to the highest quality standards.

Precisely designed thermally broken **tongue and groove section joints** reduce air infiltration and creates weather-tight seal.

The steel front and back 3-layer sandwich construction with **insulating polystyrene core** increases energy savings and provides a very smooth and quiet door operation.

Galvanized **finished painted steel** provides superior corrosion resistance for years of trouble-free performance.

The bottom weather seal **keeps out wind, rain, debris and other elements** for added energy savings.

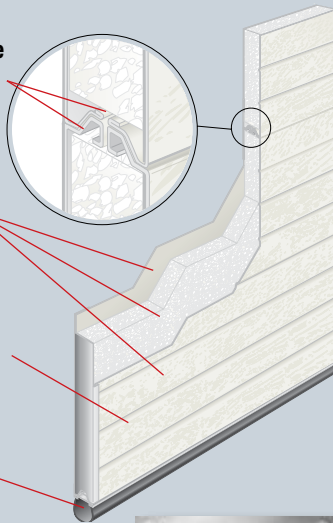

#### Energy-efficient polystyrene core



The H-340S series of doors offer enhanced energy efficiency and sound-dampening qualities. The polystyrene insulation fills the top of the door channel for maximum insulation. With 2" thick sections both series gives you an R value of 7.4.

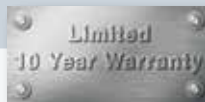

#### Engineering Excellence

Double end stile design adds to the door's overall structural integrity and its long term performance

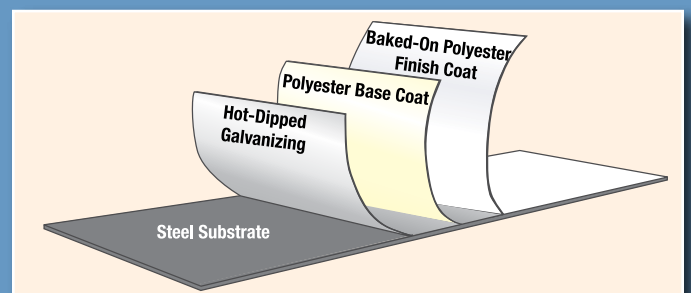

#### Durability

H-340S door panels are prepared inside and out to offer maximum protection against the adverse effects of the elements to provide you with a long-lasting surface finish and reduced maintenance cost.

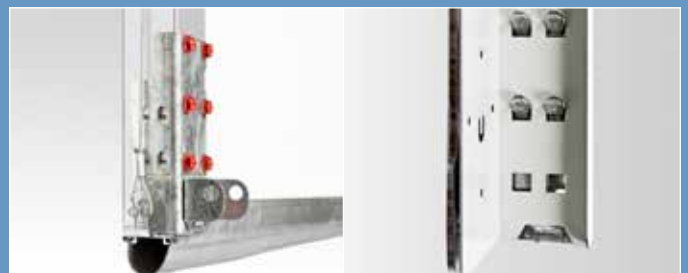

#### Safety

Hörmann H-340S doors utilize safety fixtures on their bottom sections for added safety for your peace of mind.

## Panel Designs



**Microgroove design**

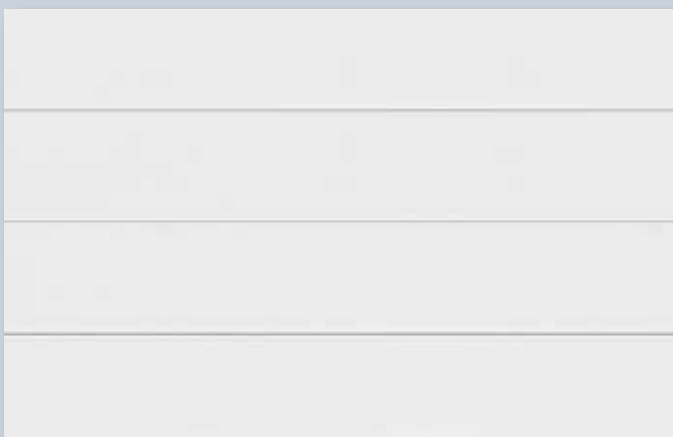

**Flush design**

## Surface Finish

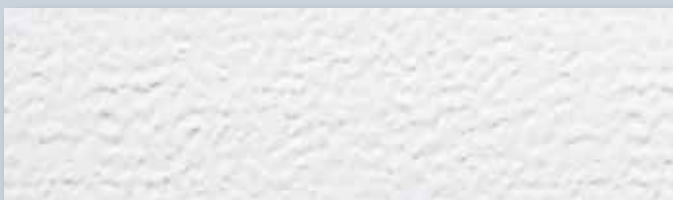

**Stucco**

Regardless of the color you choose, all of our surface finishes provide a durable baked-on polyester finish coat offering a long-lasting attractive appeal.

## Colors

**White**

**Sandstone**

**Brown**

**Metallic Silver**

*All colors shown as accurately as printing technology allows.*

## Window Options



**Window 24" X 6"**

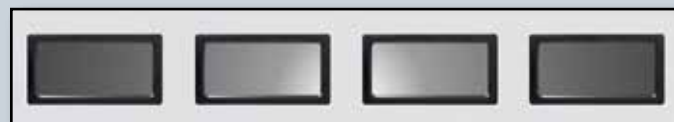

**Window 24" X 12"**

Single pane is standard for non-insulated doors. Insulated glass is standard for both vinyl back insulated and sandwich doors.

The number of windows available per section depends on the door width. For raised panel designs, see dealer for window options.

### Window Arrangements (24" X 6" & 24" X 12")

Door Width	Maximum No. of Windows
Up to 9' 2"	2
9' 3" to 12' 2"	3
12' 3" to 16' 2"	4
16' 3" to 19' 2"	5
19' 3" to 24' 2"	6



Series	H-340S
Steel Thickness	25 ga.
Section Thickness	1½ in.
R - Value	7.4
Polystyrene Core Insulation	Standard
<b>Panel Designs</b>	
Microgroove	Standard
Flush	Standard
<b>External Textures</b>	
Microgroove	Stucco
Flush	Stucco
<b>Available Colors</b>	
White	Standard
Sandstone	Standard
Brown	Standard
Metallic Silver (RAL 9006)	Optional
<b>Windows Options</b>	
24" X 6"	Optional
24" X 12"	Optional
<b>Warranty</b>	
Sections	10 years
Hardware	1 year

## Section Arrangements

Door Height	No. of Sections
Up to 8'0"	4
8'9" to 10'0"	5
10'6" to 12'0"	6
12'3" to 14'0"	7
14'3" to 16'0"	8
16'3" to 18'0"	9

## Additional Options

- Various track options
- Full perimeter weatherseal
- Top header seal
- Keyed locks
- Extended cycle springs - 25k, 50k & 100k
- Special windload ratings
- Chain hoist operation
- Full range of electric openers and safety devices

## Head Room and Side Room Dimensions (typical)

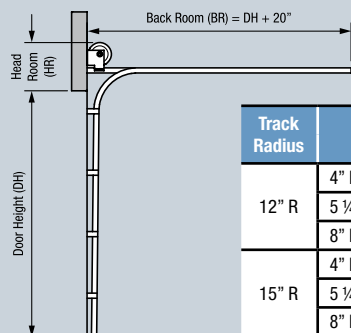

### Standard Lift Doors

Track Radius	Drum Type	Head Room	
		2" Track	3" Track
12" R	4" Dia. Standard Lift	11"	—
	5 ¼" Dia. Standard Lift	14½"	—
	8" Dia. Standard Lift	*Special	—
15" R	4" Dia. Standard Lift	14 ¾"	15 ¾"
	5 ¼" Dia. Standard Lift	15 ½"	17 ½"
	8" Dia. Standard Lift	18 ¾"	20 ½"

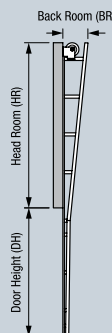

### Vertical Lift Doors

Head Room		Back Room	
2" Track	3" Track	2" Track	3" Track
DH + 9"	DH + 9"	16"	16"

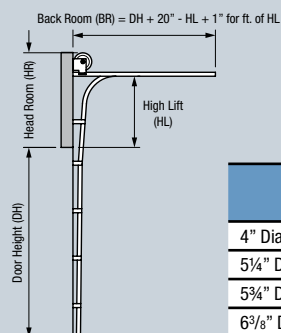

### High Lift Doors

Drum Type	Head Room	
	2" Track	3" Track
4" Dia. High-Lift Drum 54" of HL	HL + 8¼"	HL + 9¼"
5¼" Dia. High-Lift Drum 54" of HL	HL + 9¼"	HL + 10¼"
5¾" Dia. High-Lift Drum 120" of HL	HL + 12"	HL + 13"
6¾" Dia. High-Lift Drum 164" of HL	HL + 12¾"	HL + 13¾"

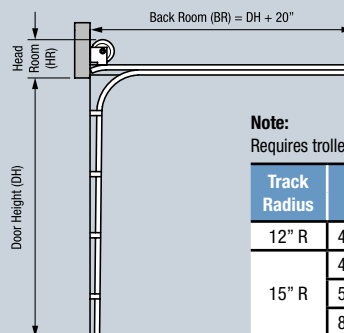

### Low Head Room Doors

**Note:**  
Requires trolley type Opener with brake for door to clear header.

Track Radius	Drum Type	Head Room	
		2" Track	3" Track
12" R	4" Dia. Standard Lift	10"	—
	4" Dia. Standard Lift	10"	11½"
15" R	5¼" Dia. Standard Lift	11"	12½"
	8" Dia. Standard Lift	14½"	16"

## Side Room Dimensions

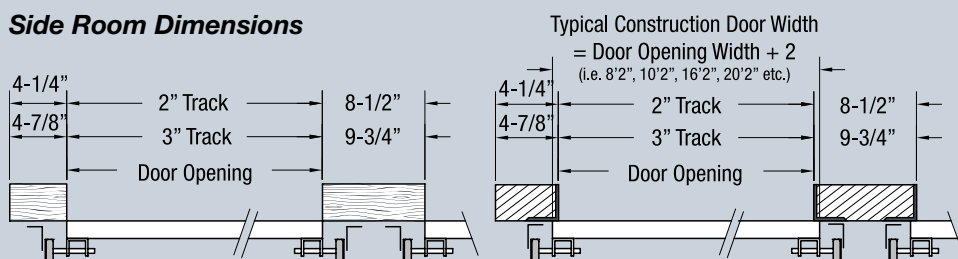

### Continuous Angle Track Wood Jambs

### Reverse Angle Track Steel / Masonry Jambs

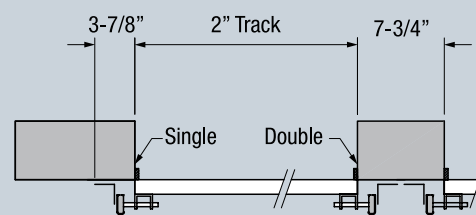

### Bracket Mounted Track

Please contact us for further details.

# CSI Product Specifications

## SECTION 08360 - SECTIONAL DOORS

### H-340S Series Insulated Steel Sectional Doors

#### PART 1 – GENERAL

##### 1.01 RELATED DOCUMENTS

- A. All of the Contract Documents, including General and Supplementary Conditions, and Division 1 General Requirements, apply to the work of this Section.

##### 1.02 SUMMARY

- A. The work of this Section includes upward-acting sectional doors.
- B. Related Sections: Other specification sections which directly relate to the work of this section include, but are not limited to, the following:
  - 1. Section 05500 - Miscellaneous Metal; metal framing and supports.
  - 2. Section 08710 - Finish Hardware; key cylinders for locks.
  - 3. Section 09900 - Painting; field painting.
  - 4. Section 16100 - Electrical; wiring.

##### 1.03 SUBMITTALS

- A. Product Data: Submit manufacturer's product data and installation instructions for each type of sectional door. Include both published data and any specific data prepared for this project.
- B. Shop Drawings: Submit shop drawings for approval prior to fabrication. Include detailed plans, elevations, details of framing members, required clearances, anchors, and accessories. Include relationship with adjacent materials.

##### 1.04 QUALITY ASSURANCE

- A. Manufacturer: Sectional doors shall be manufactured by a firm with a minimum of five years' experience in the fabrication and installation of sectional doors. Manufacturers proposed for use, which are not named in these specifications, shall submit evidence of ability to meet performance and fabrication requirements specified, and include a list of five projects of similar design and complexity completed within the past five years.
- B. Installer: Installation of sectional doors shall be performed by the authorized representative of the manufacturer.
- C. Single-Source Responsibility: Provide doors, tracks and accessories from one manufacturer for each type of door. Provide secondary components from source acceptable to manufacturer of primary components.
- D. Pre-Installation Conference: Schedule and convene a pre-installation conference just prior to commencement of field operations, to establish procedures to maintain optimum working conditions and to coordinate this work with related and adjacent work.

##### 1.05 DELIVERY, STORAGE, AND HANDLING

- A. Deliver materials and products in labeled protective packages. Store and handle in strict compliance with manufacturer's instructions and recommendations. Protect from damage from weather, excessive temperatures and construction operations.

#### PART 2 – PRODUCTS

##### 2.01 ACCEPTABLE MANUFACTURER

- A. Provide sectional doors by Hörmann LLC, Sparta, Tennessee; Telephone 877-654-6762 or 630-859-3000; Fax 630-859-8122.

##### 2.02 STEEL SECTIONAL DOORS

- A. Trade Reference: H-340S Series Insulated Steel Doors by Hörmann LLC.
- B. Sectional Door Assembly: Insulated steel door assembly with tongue and groove meeting rails to form weather tight joints and provide full-width interlocking structural rigidity. Units shall have the following characteristics:
  - 1. Panel Thickness: 1 1/2"
  - 2. Exterior Surface: Microgroove or flush
  - 3. Section Joint: Sections to form a weather tight tongue and groove fit.
  - 4. Material: G-40 galvanized steel, complying with ASTM A-929, A-653, exterior and interior skins bonded with high quality silicone based adhesive that adheres to polystyrene core.
  - 5. Exterior Skin: Minimum 25 gauge exterior steel face sheet.
  - 6. Interior Skin: 27 gauge interior steel face sheet with stucco texture. Color: white, brown, sandstone or metallic silver.
  - 7. End Caps: 20 gauge galvanized steel primed with white baked-on polyester top coat.
  - 8. Standard Springs: 10,000 cycles. (Higher cycles available)
  - 9. Insulation: HCFC-free Polystyrene, R-value 7.4
  - 10. Partial Glazing of Steel Panels: (Insulated or non-insulated double strength glass available.) (Not Required.)
  - 11. Full Glazing Requiring Aluminum Sash Panels: (Acrylic glazing.) (1/8" double strength glass.) (Insulated double strength glass.) (Not Required.)
- C. Finish and Color: Factory-applied baked-on White, Sandstone, Brown or Industrial Grey polyester.
- D. Wind load Design: ANSI/DASMA 108 and 115 standards and as required by code.
  - Hardware: 14 Gauge galvanized steel hinge assembly and fixtures. Ball bearing rollers with hardened steel races.
  - Lock: Interior mounted slide lock. (Keyed lock.)
  - Weather-stripping: Flexible PVC on bottom section. (Header seal and jamb weather-stripping.)
  - Track: Provide track as recommended by manufacturer to suit loading required and clearances available. Note: Select type of operation
- E. Manual Operation: Manual pull rope. (Chain hoist.)
- F. Electric Motor Operation: Provide UL listed electric operator, size and type as recommended by manufacturer to move door in either direction at not less than 2/3 foot nor more than 1 foot per second.
  - 1. Entrapment Protection: (Pneumatic sensing edge up to 18' wide) (Electric sensing edge.) (Photoelectric sensors.)
  - 2. Operator Controls: (Push-button) (Key) (Push-button and key) operated control stations with open, close, and stop buttons for (flush) (surface) mounting, for (interior) (exterior) (both interior and exterior) location. Note: Select from below as applicable
  - 3. Special Operation: (Pull-rope release automatic opening device, vehicle detector operation, radio control operation, card reader control, photocell operation, door timer operation, commercial light package, explosion and dust ignition proof control wiring.)

#### PART 3 – EXECUTION

##### 3.01 PREPARATION

- A. Take field dimensions and examine conditions of substrates, supports, and other conditions under which this work is to be performed. Do not proceed with work until unsatisfactory conditions are corrected.

##### 3.02 INSTALLATION

- A. Strictly comply with manufacturer's installation instructions and recommendations. Coordinate installation with adjacent work to ensure proper clearances and allow for maintenance.
- B. Instruct Owner's personnel in proper operating procedures and maintenance schedule.

##### 3.03 ADJUSTING AND CLEANING

- A. Test sectional doors for proper operation and adjust as necessary to provide proper operation without binding or distortion.
- B. Touch-up damaged coatings and finishes and repair minor damage. Clean exposed surfaces using non-abrasive materials and methods recommended by manufacturer of material or product being cleaned.

2020 Hörmann LLC. All Rights Reserved. A copyright license to reproduce this specification is hereby granted to non-manufacturing architects, engineers and specification writers

#### AVAILABLE FROM:



**Call us ► 1 877 OK HORMANN (1-877-654-6762)**

Hörmann LLC, 450 Airport Road, Sparta, TN 38583

Phone: 630-859-3000 Fax: 630-859-8122

Email: info1@hormann.us www.hormann.us



Everything you've wanted in a commercial door, and more.

**HÖRMANN**