

Therma Tech 3400

Formerly marketed as Orion 3400

HÖRMANN

BETTER



Door: Ltd Lifetime



Hardware: 3 yr



Springs: 3 yr

- **R-7.4** Thermal Rating
- Steel Construction
- 1½" Sections
- 12 Colors
- 7 Panel Designs
- 26 Window Designs

Thermal Rating



Customizations



Low Maintenance



Luxury Level



PANEL DESIGN OPTIONS

- 1 Traditional
- 2 Ranch
- 3 Country
- 4 Cottage
- 5 Shaker
- 6 Flush
- 7 Microgroove

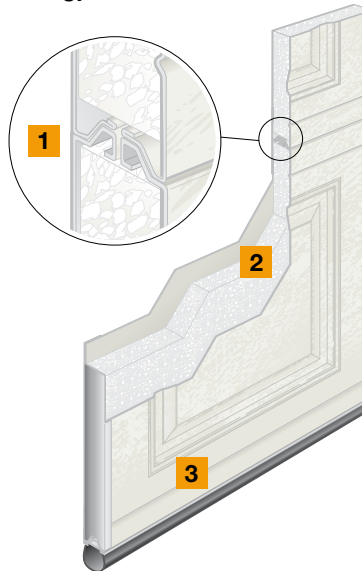
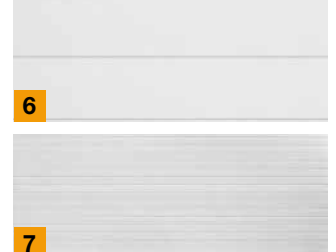
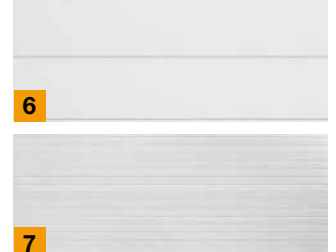
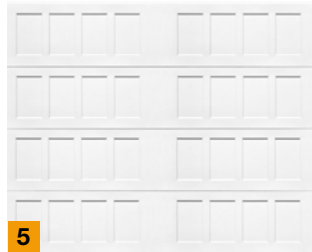
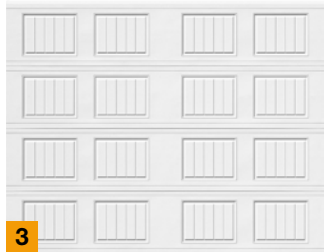
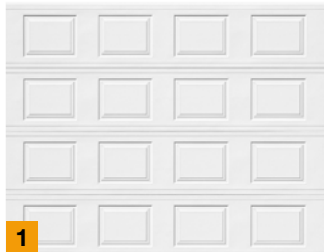

Precisely Designed 1 Tongue & Groove

Thermally broken section joints reduce air infiltration and create weather tight seal.

3-Layer Sandwich 2 Construction

Steel front and back construction with insulating polystyrene core increases energy savings and provides a very smooth and quiet operation.

Well-defined Panel 3 Embossments

Easy to clean woodgrain texture, galvanized and finish painted steel provide years of trouble-free performance and beauty.

Hörmann Innovations

Safety Bottom Fixture



Hörmann garage doors utilize safety fixtures on their bottom sections for added safety for your peace of mind.

Superior and Safe Windows



Hörmann window insert frames are recessed to the panel surface to give your door a cleaner look. Tempered safety glass panes offer extra layer of safety in case of breakage.

Aluminum Bottom Seal Retainer



Hörmann minimizes floor corrosion by utilizing an aluminum bottom seal retainer that never rusts and is more durable than brittle plastic retainers.

COLOR OPTIONS



1 White*	6 Teratone
2 Sandstone*	7 Black
3 Almond	8 Hunter Green
4 Desert Tan	9 Golden Oak
5 Brown*	10 Medium Oak
	11 Walnut
	12 Rosewood

Color application method will be at the discretion of the manufacturer.

*Microgroove design limited to White, Brown and Sandstone

All colors shown as accurately as printing technology allows.

WINDOW DESIGN OPTIONS

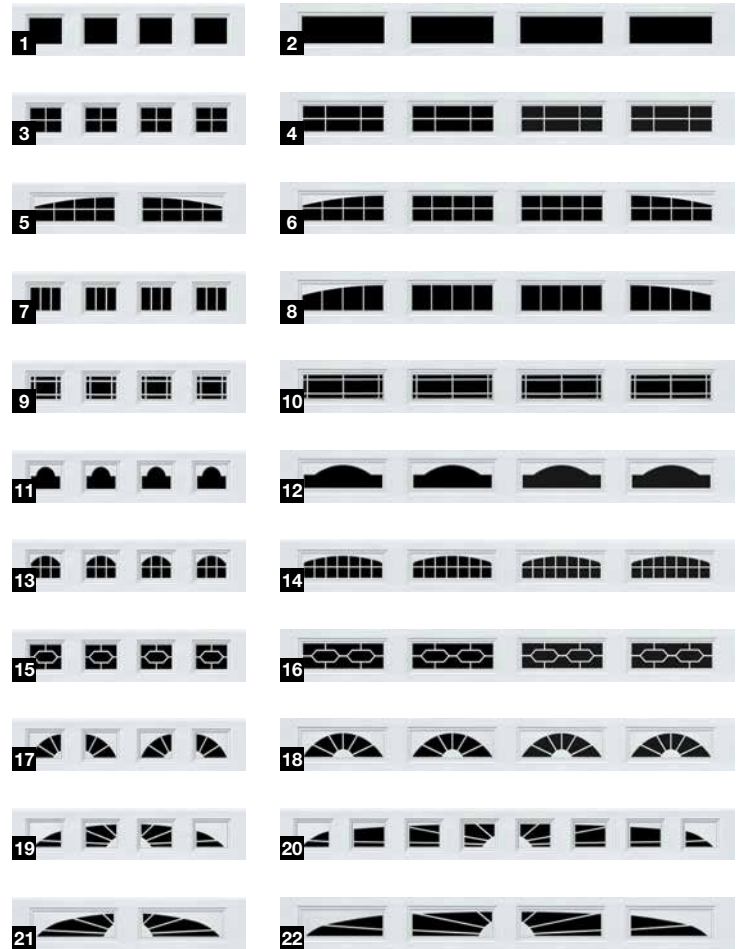

Non-insulated glass.

- | | |
|-----------------------------|-----------------------------|
| 1 Standard Short | 2 Standard Long |
| 3 Cross Short | 4 Cross 6 Long |
| 5 Cross Arch | 6 Cross 8 & Cross Arch Long |
| 7 Stockbridge Short | 8 Stockbridge & Arch Long |
| 9 Prairie Short | 10 Prairie Long |
| 11 Cathedral Short | 12 Cathedral Long |
| 13 Cascade Short | 14 Cascade Long |
| 15 Diamond Short | 16 Diamond Long |
| 17 Sherwood Short | 18 Sherwood Long |
| 19 Sunrise Short (4 panels) | 20 Sunrise Short (8 panels) |
| 21 Sunrise Long (2 panels) | 22 Sunrise Long (4 panels) |



Call toll free

Eastern & Central US: 877.654.6762
Western US: 800.522.2264
Canada: 833.743.2443

Contact

Email: info@hormann.us
Website: hormann.us



Follow us on social media



AVAILABLE FROM:

